

2719 3

Avenue NE

Calgary, Alberta



2 Freestanding Buildings Totaling $\pm 65,810$ SF on ± 7.00 Acres



2719 3 Avenue NE
Calgary, Alberta | T2A 2L5



Zoning	I-G (Industrial-General)	+ 2 freestanding buildings totaling ±65,810 SF on ±7.00 acres
Building Rentable Area	Bldg A: ±34,764 SF Bldg B: ±31,046 SF	+ Potential to lease buildings together or separately
Total Site Area	±7.00 Acres	+ Multiple access points to the site
Loading	Bldg A: 3 x Drive-in Bldg B: 6 x Dock, 4 x Drive-in	+ Substantial paved yard area
Power	600 Amps per building (TBV)	+ Fully sprinklered buildings
Operating Costs	Self Managed	+ Excellent central location with easy access to Memorial Drive, 16 Avenue and Deerfoot Trail NE
Lease Rate	Market	
Availability	Immediately	

Building A

Building Rentable Area	Office:	±5,166 SF
	Warehouse:	±29,598 SF
	Total Rentable Area:	±34,764 SF
Loading	1 x Drive-in (20'x14'), 1 x Drive-in (18'x14'), 1 x Drive-in (14'x14')	
Power	600 Amps (TBV)	
Operating Costs	Self Managed	
Lease Rate	Market	
Availability	Immediately	

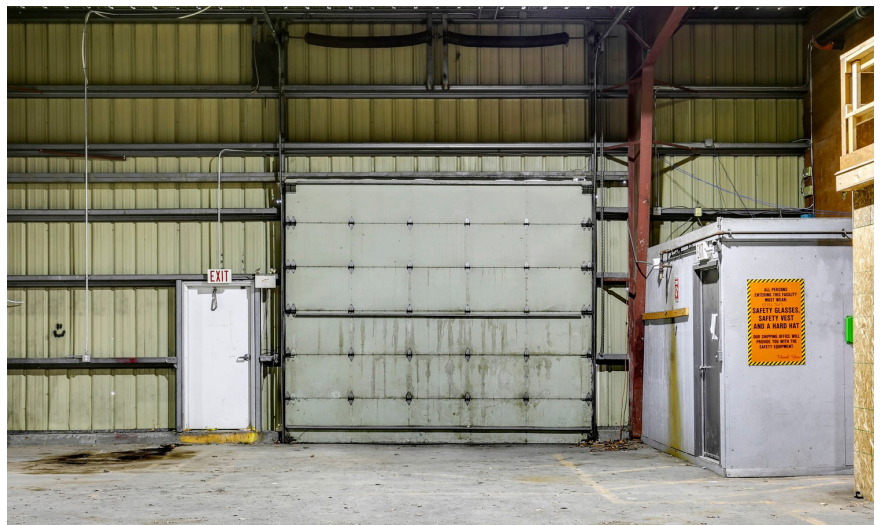

Building A Rentable Area Breakdown

±5,166

Office (SF)

±29,598

Warehouse (SF)

±34,764

Total Rentable Area (SF)

Floor Plan

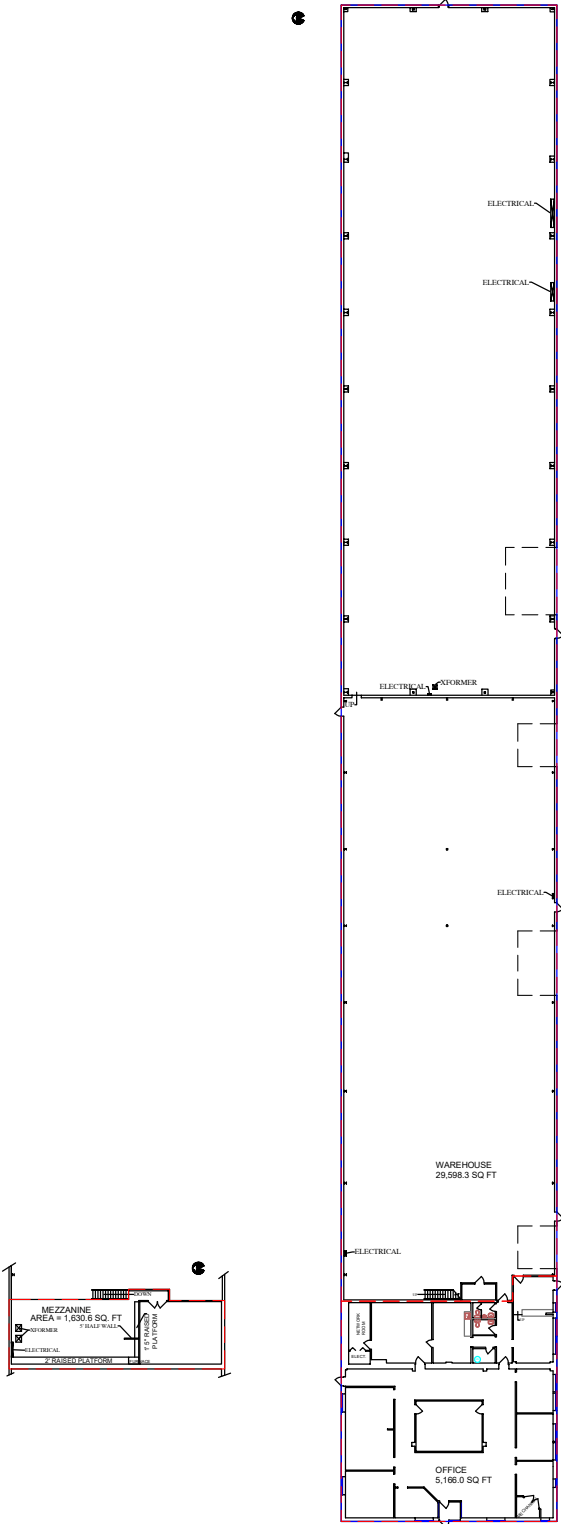

Building B

Building Rentable Area	Office:	±2,480 SF
	Warehouse:	±28,566 SF
	Total Rentable Area:	±31,046 SF
Loading	6 x Dock, 2 x Drive-in (12'x14'), 1 x Drive-in (14'x16'), 1 x Drive-in (14'x14')	
Power	600 Amps (TBV)	
Operating Costs	Self Managed	
Lease Rate	Market	
Availability	Immediately	



Building B Rentable Area Breakdown

±2,480
Office (SF)

±28,566
Warehouse (SF)

±31,046
Total Rentable Area (SF)

Floor Plan

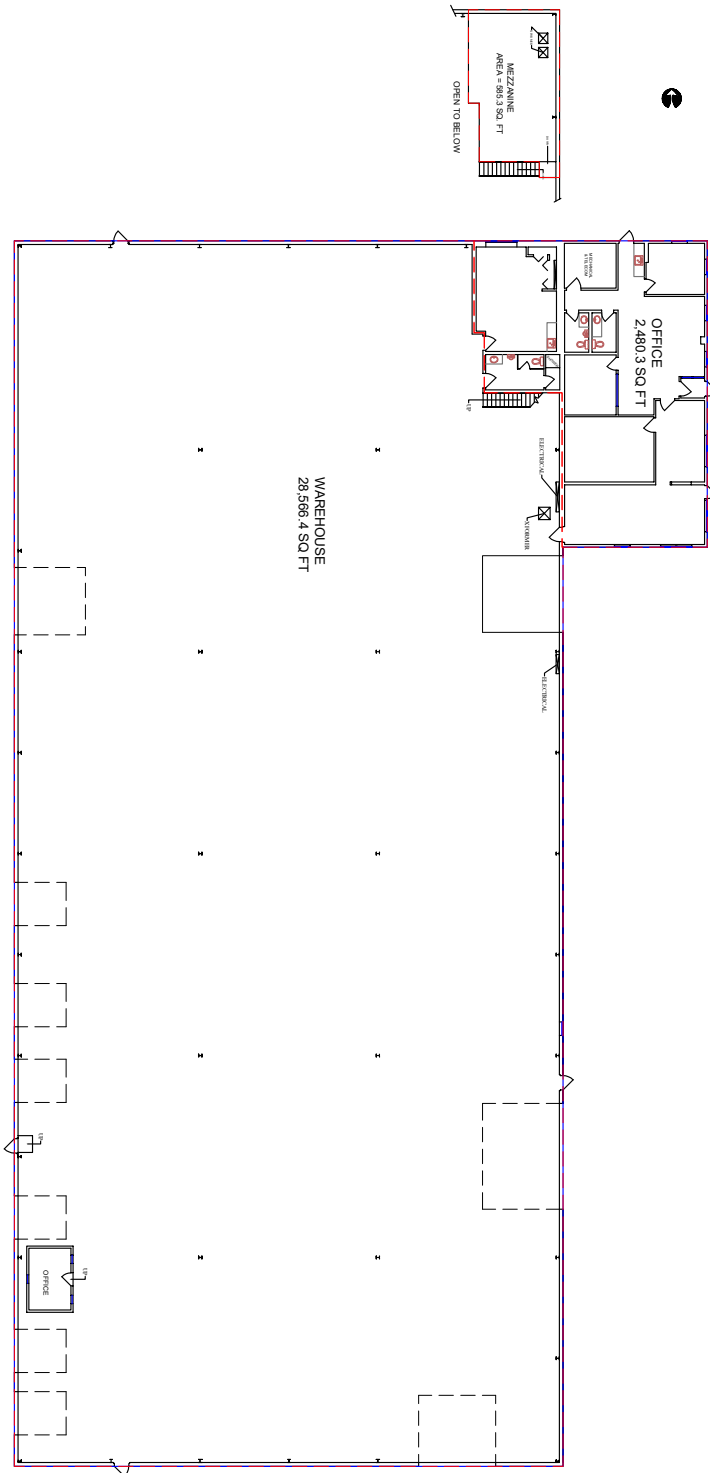



Contact Us

Iain Ferguson

Vice Chairman
+1 403 750 0803
iain.ferguson@cbre.com
*Lead Broker

Evan Renwick

Associate Vice President
+1 403 750 0807
evan.renwick@cbre.com
*Lead Broker

Luke Hamill

Senior Vice President
+1 403 294 5707
luke.hamill@cbre.com

Cameron Woods

Associate Vice President
+1 403 303 4562
cameron.woods@cbre.com

Blake Ellis

Associate Vice President
+1 403 750 0519
blake.ellis@cbre.com

This disclaimer shall apply to CBRE Limited, and to all divisions of the Corporation ("CBRE"). The information set out herein (the "Information") has not been verified by CBRE, and CBRE does not represent, warrant or guarantee the accuracy, correctness and completeness of the Information. CBRE does not accept or assume any responsibility or liability, direct or consequential, for the Information or the recipient's reliance upon the Information. The recipient of the Information should take such steps as the recipient may deem necessary to verify the Information prior to placing any reliance upon the Information. The Information may change and any property described in the Information may be withdrawn from the market at any time without notice or obligation to the recipient from CBRE.

Mapping Sources: Canadian Mapping Services canadamapping@cbre.com; DMTI Spatial, Environics Analytics, Microsoft Bing, Google Earth.